

ORIFICES

Burner / Torch	Orifice	Burner / Torch	Orifice	Burner / Torch	Orifice
FL-1	127115	FV-1	728036	FV-70	127975
FL-2	127115	FV-15	728136	FV-71	127975
FL-3 (L or S)	127115	FV-16	728137	FV-80	127985
FL-4	127415	FV-20	897550	FV-90	127957
FL-5	127415	FV-21	897550	FV-91	127957
FL-6 (L or S)	127715	FV-30	897750	MK-1	129251
FL-6-M	127615	FV-31	897750	MK-2	129252
FL-6-MB	127616	FV-40	127945	SK-1	129250
FL-7 (S)	127715	FV-41	127945	TK-10	129210
FL-8	127415	FV-50	897950	TK-30	127115
FL-9	127915	FV-60	127965	TK-40	129200
FL-10	127915	FV-61	127965	TK-50	129201

High Pressure Pilot Assembly

Our high pressure pilot assembly is used for a wide variety of applications. It is complete with a weldable mounting bracket & thermocouple holder. The inlet connection is a 1/4" copper compression or 1/8" mpt. Individual parts are also available.

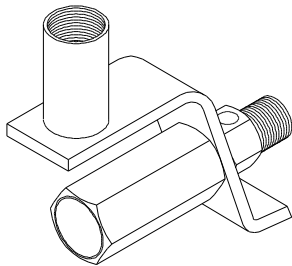

- Complete Assembly**
p/n - 126200
- Orifice**
p/n - 129510
- Burner Head**
p/n - 129520
- Bracket**
p/n - 129530

Low Pressure Pilot Assembly

Our low pressure pilot assembly is used mainly for heater & furnace applications. It operates on propane or natural gas at pressures less than 1/2 psi. It includes a mountable bracket with thermocouple holder.
(thermocouple is not included)

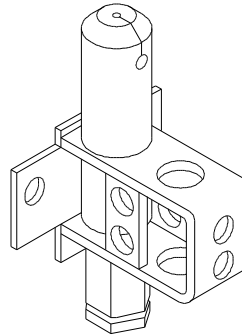

- Complete Assembly**
p/n - 126100
- Propane Orifice**
p/n - 129501
- Natural Gas Orifice**
p/n - 129502

Valve/Orifice Assembly

Our exclusive valve / orifice assemblies are used in the FV-5, FV-10, FV-11 and FV-12 Torches.

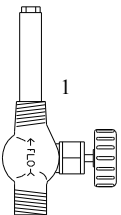

1. Valve/Orifice Assembly, 600,000 btu/h, used in the FV-10 and the FV-12 torch

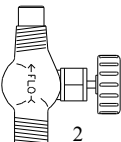

2. Valve/Orifice Assembly, 400,000 btu/h, used in the FV-5 and the FV-11 torch.

VERTICAL BURNER ADAPTER p/n - 125001

Designed to allow almost any FV series or FL series burner to be mounted & operated in the vertical position.

Not for use on the TK series burners, FL-6-M burner has a special adapter. Please call for assistance. Burner not included.

